



**MOROOKA**

# CRAWLER CARRIER



## CARRIER for SOFT, SANDY and ROUGH TERRAIN

Durable Rubber Tracks : The rubber tracks offered on our Morooka carriers are the result of over 50 years of joint development from Bridgestone and Morooka. The rubber tracks combine the characteristics of a tire equipped vehicle, such as speed and a smooth ride, while providing the traction of a steel track. Rubber tracks offer the best of all worlds with low ground pressure, high performance movement and excellent traction.



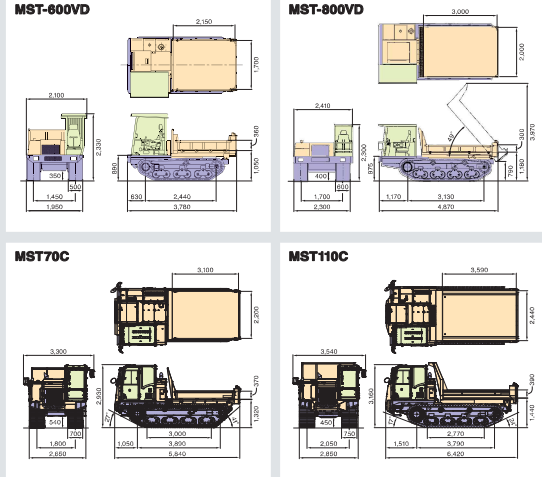
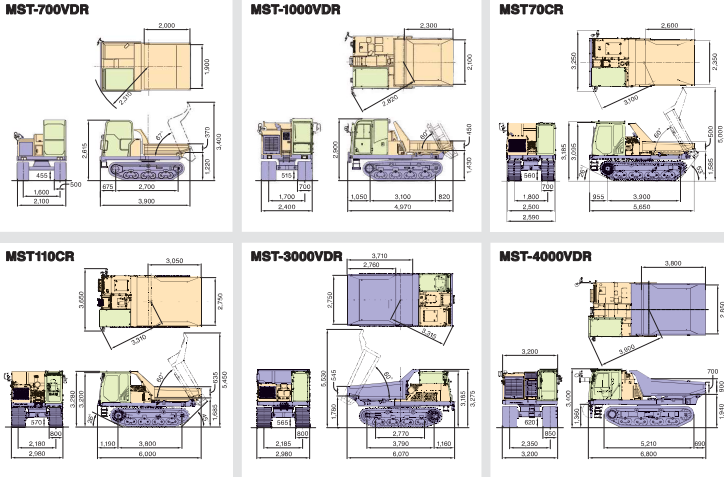

### Specifications

#### "KURU-KURU" Carrier Series

MODEL	MST-700VDR	MST-1000VDR	MST70CR	
PERFORMANCE	Maximum Payload	4,000	5,500	7,000
	Loading Capacity (Struck / Heaped)	1.48 / 1.8	1.86 / 2.69	2.8 / 4.15
	Speed (High / Low)	10.8 / 7.6	9.6 / 8.7	10.0 / 7.4
MACHINE DIMENSION & WEIGHT	Ground Pressure (Empty / Laden)	25.9 / 46.8	26.8 / 42.9	35.6 / 54.6
	Machine Weight	4,930	9,140	13,500
	Overall Length	3,900	4,970	5,650
	Overall Width	2,100	2,400	3,250
	Overall Height	2,615	2,900	3,185
	Min. Ground Clearance	455	515	570
DUMP BED (INNER)	Crawler Width	500	700	700
	Overall Length	2,000	2,300	2,600
	Overall Width	1,900	2,100	2,350
ENGINE	Overall Height	370	450	500
	Name	KUBOTA V3307-CH-T-YDN	CAT C4.4	KUBOTA V5009
TANK CAPACITY	Nominal Output	53 (17.4) / 2,200	93 (125.9) / 2,200	157 (213.9) / 2,200
	Fuel Capacity	105	140	230
	Hydraulic Oil Tank Capacity	-	54	125
EMISSION STANDARD	DEF Tank Capacity	-	19	45
		Tier4 Final EU Stage V	Tier4 Final EU Stage IV	Tier4 Final EU Stage V

#### "KURU-KURU" Carrier Series

MODEL	MST110CR	MST-3000VDR	MST-4000VDR	
PERFORMANCE	Maximum Payload	11,000	15,000	20,000
	Loading Capacity (Struck / Heaped)	4.36 / 6.17	5.4 / 7.61	7.8 / 10.25
	Speed (High / Low)	11.8 / 7.6	12.07 / 8.05	11.7 / 7.3
MACHINE DIMENSION & WEIGHT	Ground Pressure (Empty / Laden)	35.4 / 59.7	36.7 / 69.5	45.0 / 81.4
	Machine Weight	16,800	16,900	24,740
	Overall Length	6,000	6,070	6,800
	Overall Width	3,650	2,980	3,200
	Overall Height	3,280	3,275	3,400
	Min. Ground Clearance	570	565	620
DUMP BED (INNER)	Crawler Width	800	800	850
	Overall Length	3,050	2,760	3,800
	Overall Width	2,750	2,750	2,850
ENGINE	Overall Height	635	915	700
	Name	CAT C7.1	CAT C7.1 ACERT	CAT C9.3B
TANK CAPACITY	Nominal Output	186 (252.9) / 2,200	225 (306.2) / 2,200	310 (421.5) / 2,200
	Fuel Capacity	300	222	400
	Hydraulic Oil Tank Capacity	154	177	195
EMISSION STANDARD	DEF Tank Capacity	32	32	-
		Tier4 Final EU Stage V	Tier4 Final EU Stage V	Tier4 Final EU Stage V

Specifications are subject to change without notice.

### Specifications

#### Crawler Carrier Rigid Series

MODEL	MST-600V	MST-800V	
PERFORMANCE	Maximum Payload	3,800	4,500
	Loading Capacity (Struck / Heaped)	1.28 / 1.95	1.82 / 2.95
	Speed (High / Low)	10.0 / 7.0	11.0 / 8.3
MACHINE DIMENSION & WEIGHT	Ground Pressure (Empty / Laden)	24.8 / 46.4	22.5 / 39.1
	Machine Weight	4,400	6,570
	Overall Length	3,780	4,870
	Overall Width	2,100	2,410
	Overall Height	2,330	2,300
	Min. Ground Clearance	350	400
DUMP BED (INNER)	Crawler Width	500	600
	Overall Length	2,150	3,000
	Overall Width	1,700	2,000
ENGINE	Overall Height	390	300
	Name	KUBOTA V3307	Mitsubishi 4D34
TANK CAPACITY	Nominal Output	55 (74.2) / 2,200	81 (110.1) / 2,200
	Fuel Capacity	75	130
	Hydraulic Oil Tank Capacity	-	-
EMISSION STANDARD	DEF Tank Capacity	-	-
		Tier4 Interim EU Stage IIIA	Tier2 EU Stage II

#### Crawler Carrier Rigid Series

MODEL	MST70C	MST110C	
PERFORMANCE	Maximum Payload	7,000	11,000
	Loading Capacity (Struck / Heaped)	2.52 / 4.18	3.42 / 5.79
	Speed (High / Low)	9.3 / 6.5	10.5 / 7.5
MACHINE DIMENSION & WEIGHT	Ground Pressure (Empty / Laden)	26.8 / 43.2	24.5 / 43.5
	Machine Weight	11,500	14,200
	Overall Length	5,840	6,420
	Overall Width	3,300	3,540
	Overall Height	2,930	3,160
	Min. Ground Clearance	540	480
DUMP BED (INNER)	Crawler Width	700	750
	Overall Length	3,100	3,550
	Overall Width	2,200	2,440
ENGINE	Overall Height	370	390
	Name	Cummins B6.7	Cummins B6.7
TANK CAPACITY	Nominal Output	168 (228.4) / 2,200	186 (252.9) / 2,200
	Fuel Capacity	251	266
	Hydraulic Oil Tank Capacity	125	125
EMISSION STANDARD	DEF Tank Capacity	33.4	33.4
		Tier4 Final EU Stage V	Tier4 Final EU Stage V

Specifications are subject to change without notice.



# Living tradition-World No.1 tracked dumper Crawler Carrier Rigid Series

## Consideration for the Environment

### Auto Deceleration

When idling continues for a certain period of time, engine speed automatically lowers to improve fuel efficiency, noise and CO<sub>2</sub> emission are also reduced. (MST70C/MST110C)



### MOROOKA Tracked dumpers working in the world.

The pioneer in the field of rough terrain transport, MOROOKA's MST series have gained the No.1 market share not only in Japan but also overseas and active all over the world. As a result of our achievement, MST series has earned a high reputation in the used equipment market as well.



## Pursuing Safety and Comfort

### List of canopy and cabin specification

Supported models		
Name	Canopy	Cabin
MST-600VD	ROPS	-
MST-800VD	Non ROPS	-
MST110C	-	ROPS/FOPS
MST-700VDR	ROPS/FOPS	-
MST-1000VDR	-	ROPS/FOPS
MST-1500VDR	-	ROPS/FOPS
MST110CR	-	ROPS/FOPS
MST-3000VDR	-	ROPS
MST-4000VDR	-	ROPS/FOPS

### highly customizable for many purposes

Morooka Carriers are customized for a variety of industries. Our carriers can be outfitted with Dump Beds, Digger Derricks, Field Service Equipment, Trimmers, Buckets, Cranes, Welding Equipment, Flat Beds, Drilling Equipment and more. Find out more about how a customized Morooka Carrier can solve your unique project needs.

Although Morooka Carriers are highly customizable for many purposes, Morooka is not responsible nor liable for the injuries or damages incurred with the additional features. Please consult with our distributors first to get the approval.

### Rigid Series

## Aiming for ease of use and safety



**MST-600VD** Max.Payload **3.8t**  
Tier4 Interim / EU Stage IIIA

**MST-800VD** Max.Payload **4.8t**  
Tier2 / EU Stage II

**MST70C** Max.Payload **7t**  
Tier4 Final / EU Stage V

**MST110C** Max.Payload **11t**  
Tier4 Final / EU Stage V

# RIGID SERIES

# 360° Rotating Crawler Carrier "KURU-KURU" Carrier Series



# "KURU KURU" SERIES



## Consideration for the Environment



### Auto Deceleration

When idling continues for a certain period of time, engine speed automatically lowers to improve fuel efficiency, noise and CO<sub>2</sub> emission are also reduced.  
(MST70CR/MST110CR/4000VDR)



## Pursuing Safety and Comfort

### For Safe Work

Backup and side cameras have been equipped to alleviate rear and right hand side blind spots.  
(MST-1000VDR/70CR/110CR/3000VDR/4000VDR)



### 360° Full Rotating Upper Structure

The 360° full rotation design dramatically reduces the need of pivot turn and spin turn. It also greatly improves work efficiency and enables operator to unload soil easily in any location.

### Improvement of durability in dump bed

Introduction of wear-resistant steel Hardox® greatly improves durability of dump bed and contributes reduction of running cost. (MST110C/110CR/4000VDR)

## "KURU-KURU" Carrier Series



**MST-700VDR** Max Payload **4t**  
Tier4 Final / EU Stage V



**MST-1000VDR** Max Payload **5.5t**  
Tier4 Final / EU Stage IV



**MST-70CR** Max Payload **7t**  
Tier4 Final / EU Stage V



**MST-110CR** Max Payload **11t**  
Tier4 Final / EU Stage V



**MST-3000VDR** Max Payload **15t**  
Tier4 Final / EU Stage V



**MST-4000VDR** Max Payload **20t**  
Tier4 Final / EU Stage V

# Strong Undercarriage for Excellent Off Road Capability

## **MOROOKA**'s Large Rubber Tracks

Since 1978, when Morooka succeeded in developing the world's first large-sized rubber tracks, Morooka has continued to provide the best undercarriages with continuous improvement.



### Rubber Crawlers

Thick, seamless rubber tracks provide outstanding durability! Morooka is the pioneer of rubber tracks. We will continue to evolve with 40 years of experience and know-how since its development.

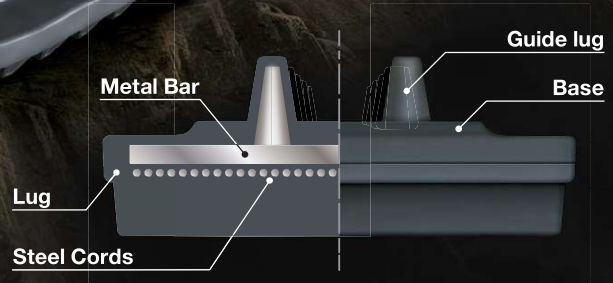

### Track Rollers

Thick and large diameter track rollers efficiently disperse the load on rubber tracks and undercarriages.

### HST System

The HST system is a very economical system using engine power to drive the hydraulic pump and motor, enabling operators to experience smooth and stable driving. The system completely eliminates the need for clutch and gear control too.

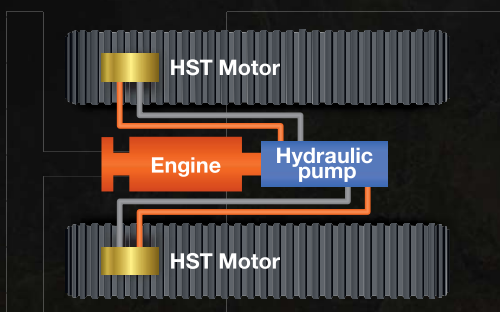

**MOROOKA**  
Morooka Co., Ltd.

Postal Code : 301-0031  
358 Shoubeeshindenmachi, Ryugasaki city, Ibaraki Prefecture, Japan  
TEL, +81-297-66-2111 FAX, +81-297-66-3110  
OVERSEAS DEPT, +81-297-86-9034  
URL : [www.morooka.co.jp](http://www.morooka.co.jp) (Japanese)  
[www.morooka.com](http://www.morooka.com) (English)

CONTACT